

SOURCE OF DESCRIPTION
BOOK 2548 PAGE 922

ACCEPTED THE S LINE
OF INTERSTATE 44 AS
BEING S67°36'30\"/>

**RESOURCE MATERIALS USED
FOR BOUNDARY DETERMINATION**

- MODOT PLANS
FOR US ROUTE 66
- SURVEY BY
WILSON SURVEYING CO, INC
DATED DECEMBER 19, 2002
- DEEDS AS SHOWN

BENCHMARK
MISSOURI DEPARTMENT OF
NATURAL RESOURCES
STATION OM ELEV. 1402.23

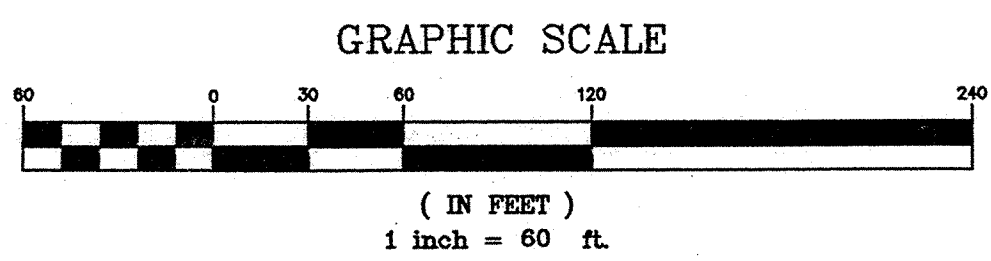

LEGEND

- = EXISTING IRON PIN EXCEPT AS NOTED
- ⊙ = 5/8" IRON PIN SET CAPPED "LS-267D"
- = STONE
- ⊕ = POWER POLE
- ⊕ = LIGHT POLE
- ⊕ = GAS METER
- ⊕ = GAS VALVE
- ⊕ = WATER METER
- ⊕ = WATER VALVE
- ⊕ = FIRE HYDRANT
- ⊕ = SEWER MANHOLE
- ⊕ = SIGN
- ⊕ = BUSH
- ⊕ = DECIDUOUS TREE
- ⊕ = CONIFER TREE
- S = SAN. SEWER LINE
- G = GAS LINE
- W = WATER LINE
- E = ELECTRIC LINE
- T = TELEPHONE LINE
- = CHAIN-LINK FENCE
- x— = WIRE FENCE
- = WOOD FENCE
- [Pattern] = ASPHALT
- [Pattern] = CONCRETE
- [Pattern] = GRAVEL

DESCRIPTION

BEGINNING 279.40 FEET SOUTH OF THE NORTHWEST CORNER OF THE WEST ONE-HALF (W1/2) OF LOT TWO (2) OF THE NORTHEAST FRACTIONAL QUARTER (NE FRL 1/4) OF SECTION ONE (1), TOWNSHIP TWENTY-NINE (29), RANGE TWENTY-ONE (21), SAID POINT BEING ON THE SOUTH RIGHT-OF-WAY LINE OF INTERSTATE HIGHWAY #44; THENCE SOUTH ALONG THE QUARTER-SECTION LINE 613.60 FEET; THENCE EAST 300.00 FEET; THENCE NORTH PARALLEL TO SAID WEST QUARTER-SECTION LINE, TO A POINT ON THE SOUTH RIGHT-OF-WAY LINE OF INTERSTATE HIGHWAY #44; THENCE SOUTHWESTERLY ALONG SAID RIGHT-OF-WAY LINE TO THE POINT OF BEGINNING, ALL IN GREENE COUNTY, MISSOURI.

ALSO:
AN EASEMENT FOR INGRESS AND EGRESS DESCRIBED AS FOLLOWS:
BEGINNING AT A POINT 893.00 FEET SOUTH AND 300.00 FEET EAST OF THE NORTHWEST CORNER OF THE WEST ONE-HALF (W1/2) OF LOT TWO (2) OF THE NORTHEAST FRACTIONAL QUARTER (NE FRL 1/4) OF SECTION ONE (1), TOWNSHIP TWENTY-NINE (29), RANGE TWENTY-ONE (21); THENCE NORTH 50.00 FEET; THENCE EAST 50.00 FEET; THENCE SOUTH AND PARALLEL TO THE WEST QUARTER-SECTION LINE, TO A POINT ON THE NORTH RIGHT-OF-WAY LINE OF OLD HIGHWAY ROUTE #66; THENCE SOUTHWESTERLY ALONG SAID RIGHT-OF-WAY LINE TO A POINT ON SAID RIGHT-OF-WAY LINE, SAID POINT IF MEASURED PERPENDICULAR TO THE WEST QUARTER-SECTION LINE, BEING 300.00 FEET FROM SAID WEST QUARTER-SECTION LINE; THENCE NORTH AND PARALLEL TO THE WEST QUARTER-SECTION LINE, 678.89 FEET TO THE POINT OF BEGINNING, ALL IN GREENE COUNTY, MISSOURI. SAID EASEMENT TO RUN IN FAVOR OF THE LAND HEREINABOVE DESCRIBED.

DECLARATION

WILSON SURVEYING CO. INC., HEREBY DECLARES TO R & L CARRIERS:

THE INFORMATION CONTAINED HEREON IS BASED ON AN ACTUAL SURVEY OF THE LAND DESCRIBED ABOVE, WHICH WAS PERFORMED TO THE BEST OF CORPORATE KNOWLEDGE AND BELIEF IN ACCORDANCE WITH THE MINIMUM STANDARDS FOR PROPERTY BOUNDARY SURVEYS AS PROMULGATED FOR THE STATE OF MISSOURI BY THE BOARD OF ARCHITECTS, PROFESSIONAL ENGINEERS AND LAND SURVEYORS; AND THE MISSOURI DEPARTMENT OF NATURAL RESOURCES; AND BASED ON INFORMATION PROVIDED BY AL LACKNEY.

MONUMENTS AND PINS SHOWN AS SET WERE PLACED UNDER MY PERSONAL SUPERVISION.

PHYSICAL EVIDENCE OF IMPROVEMENTS AS SHOWN IS FROM INFORMATION OBTAINED BY VISUAL INSPECTION OF THE PREMISES. EASEMENTS SHOWN ARE THOSE WRITTEN, PROVIDED, OR DISCOVERED AND MAY NOT BE ALL INCLUSIVE. APPARENT OWNERSHIPS AS SHOWN ARE THOSE BASED ON INFORMATION PROVIDED BY OTHERS AND DO NOT REPRESENT AN OPINION AS TO TITLE.

THE SURVEY SHOWN HEREON WAS PERFORMED TO MEET OR EXCEED THE REQUIREMENTS FOR URBAN CLASS PROPERTY.

THE PROPERTY SHOWN HEREON LIES IN A FLOOD ZONE C ACCORDING TO FLOOD INSURANCE MAP 290782 0070 B, EFFECTIVE JUNE 15, 1983.

Rick Wilson
WILSON SURVEYING CO., INC. L.C. 267D
BY RICK WILSON PLS-1970

AREA
4.7 ACRES
204,762 SQ. FT.

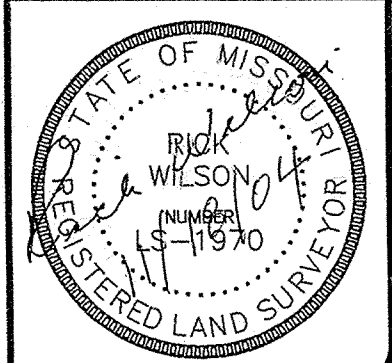

CAUTION
INFORMATION ON THIS DRAWING CONCERNING TYPE AND LOCATION OF UNDERGROUND AND OTHER UTILITIES IS NOT GUARANTEED TO BE ACCURATE OR ALL INCLUSIVE. THE CONTRACTOR IS RESPONSIBLE FOR MAKING HIS OWN DETERMINATION AS TO THE TYPE AND LOCATION OF UNDERGROUND AND OTHER UTILITIES AS MAY BE NECESSARY TO AVOID DAMAGE THERETO.



REVISION DATE	MK.

WILSON SURVEYING CO. INC.
Surveying / Engineering / Land Planning
429 S. JEFFERSON AVENUE
SPRINGFIELD, MO. 65806
TELE. 417-522-7870 FAX 417-522-7874

PREPARED FOR
R&L CARRIERS
5403 E. STATE HWY 00 STRAFFORD, MISSOURI

DRAWN BY	RDS
CREW CHIEF	APW
CHECKED	APW
DATE	OCTOBER 21, 2004
SCALE	1"=30'
JOB NO.	4099
DRAWING NO.	WC-103-716
SHEET	1 OF 1 SHEETS